



POLARLIGHT

ARCTIC NAVIGATOR

SL505XBO 2000-3000W
Xenon short arc lamp
Remote control **BUS**

POLARLIGHT SL505 RS250 XBO is a very powerful and robust searchlight, especially designed for vessels operating in harsh environmental and arctic ice conditions where long range and maximum light output is required.

The searchlight has heating systems in drum and motor unit especially designed for ice conditions.

Due to the extremely high light output from the 2000 / 3000 watt Xenon short arc lamp combined with the best optical solutions in the industry as well as high-class mechanical and electrical solutions from the most recognized suppliers on the market, SL505 provides the best possible solution for search and detection at sea. The searchlight is very maintenance friendly.

The searchlight control system is network operated (RS485) and up to 6 searchlights can be operated from each panel. The control panel includes features like speed adjustment, position indication, focus control, dimming and on/off lamp status for each searchlight etc. Many control panels can be connected together. Radio operation is also available.

FEATURES:

- Drum made of powder coated stainless steel
- Motor housing made of powder coated stainless steel
- Parabolic glass reflector. Range 15 500 meters /1 lux (2000W) /16 350 metres/1 lux (3000W)
- Hot re-strike. No cooling down time required.
- Electric lamp focus adjustment (1.5° spot to 15° flood).
- Speed: up to 20 deg/sec hor. 10 deg/sec. vert.
- Hardened front glass.
- Additional control panels can be added.
- Powerful thermostatic controlled heating elements
- To be supplied from 230 VAC/16 Amp. single phase.
- Colour temperature 6000 K.

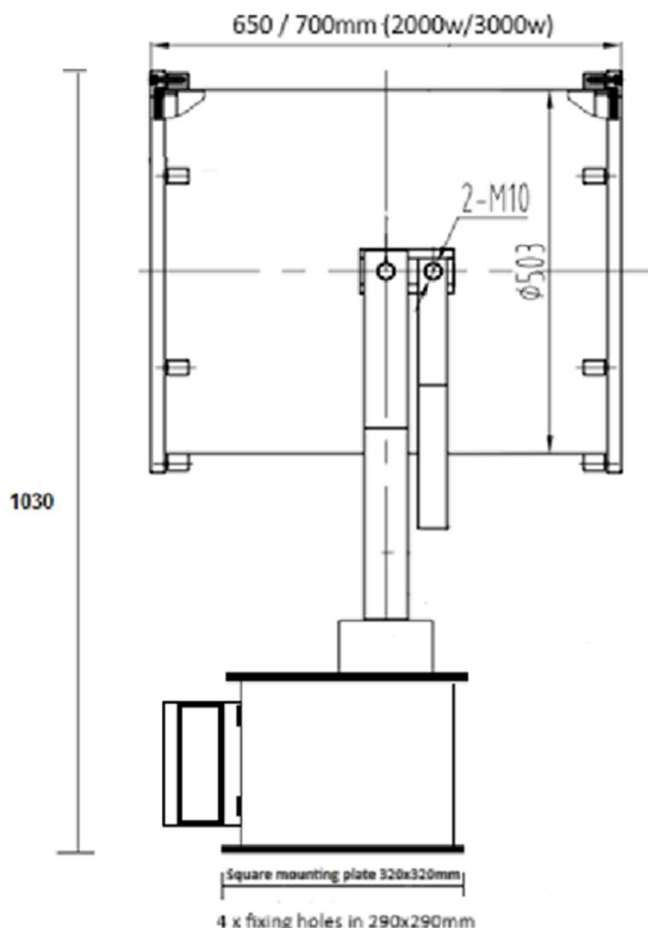

BUS control panel

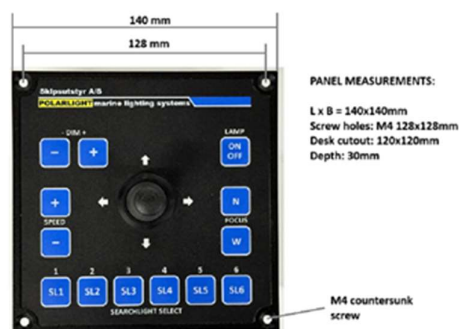

Sales agent:

SKIPSUTSTYR
Havnekvartalet 10
8370 Leknes
Tel +47 40246116/90982682
E-mail: post@skipsutstyr.com
Web: www.skipsutstyr.com